

KINDAI UNIVERSITY INTERNATIONAL EXCHANGE

近畿大学国際交流



近畿大学
KINDAI UNIVERSITY



Higashiosaka Campus (Main Campus)

Japan, Osaka

We are here in Osaka, the second biggest city in Japan. It has a population of 8.8 million, or roughly 7% of the entire population. Furthermore, approximately 230,000 non-Japanese, or 8.9% of all non-Japanese registered in Japan, reside in Osaka.



About Kindai

Kindai University was founded in 1925. Now one of Japan's largest universities, it has six campuses in western Japan and boasts research facilities across the nation. The university has over 30,000 students and more than 550,000 alumni.

The main campus has gone through extensive renovation in 2017 and boasts state-of-the-art facilities, such as innovative library, 24-hour self-study area, CNN Cafe, etc. and many more.



Academic Theater

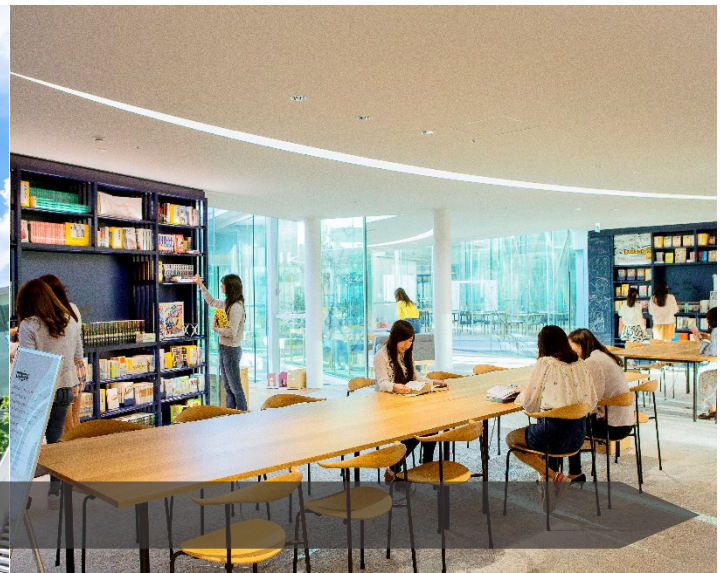



Studying at Kindai

Exchange students will study at the main campus in Osaka, which is conveniently located near the business/shopping center of Osaka within 15-minute train ride. Moreover, you can easily visit popular destinations such as Kyoto, Nara or Kobe on weekends.

As an exchange student at Kindai University, you will be able to choose courses (classes) from a variety of study areas alongside Japanese and other international students.

During your semester, you will be considered as full-time student requiring you to enroll in minimum 7 classes. Under the Kindai system, a standard subject is worth 2 credit hours. This generally equates to 2 credits in the US system or in the European Credit Transfer System (ECTS).

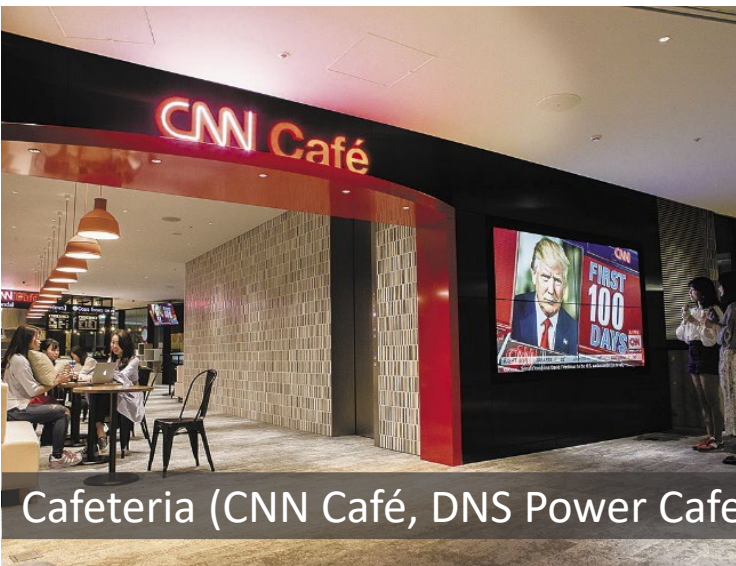



Exchange Program

Visit our
FACT
SHEET
for more info



Kindai University provides two kinds of programs:

Program A is to offer courses in English and Program B is in Japanese.

	Program A	Program B
Language	English	Japanese
Length	<ul style="list-style-type: none"> 6 months (1 semester) 1 year (2 semesters) 	
Eligibility	<ul style="list-style-type: none"> Those who do not have Japanese nationality Those who will not graduate or complete their degree program at their home institution before the end of the Kindai University exchange program 	
Academic Requirement	More than 78 in the 100 Point Scale in the "C.G.P.A. Conversion Table*" **" C.G.P.A. Conversion Table" can be seen in the Fact sheet.	
Language Requirement	TOEFL iBT 61, IELTS 6.0, CEFR B2 or equivalent	JLPT N2, N1
Course Info	<p>【List A】</p> 	<p>【List B】</p> 

Program Calendar

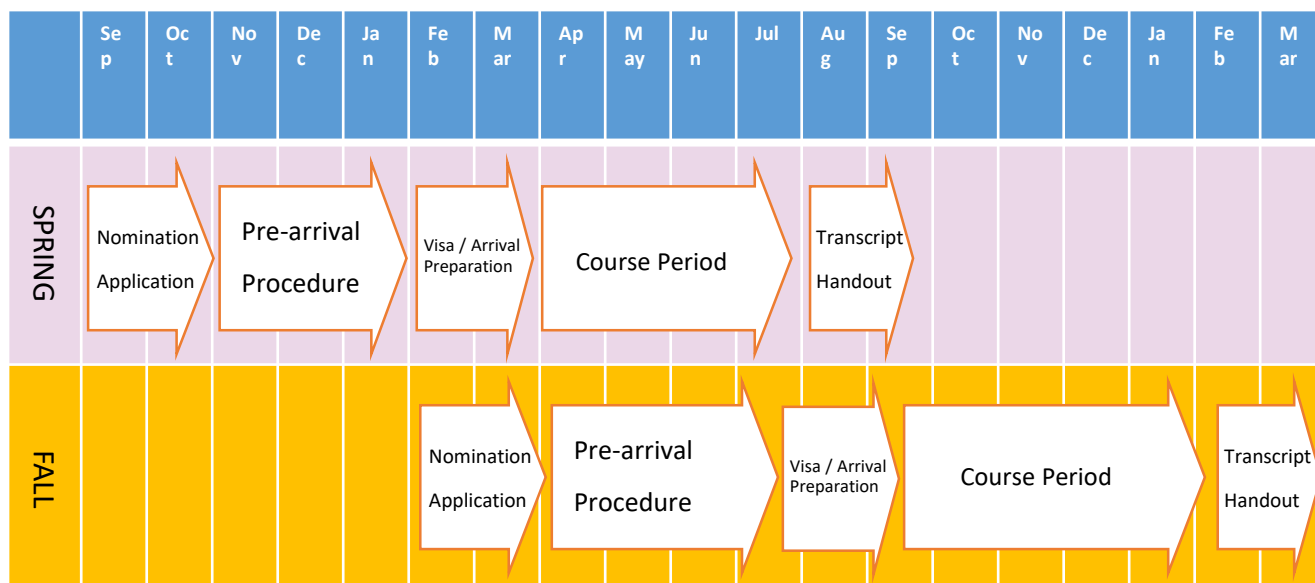

English Taught Courses (Sample)

Semester	Course Title	Semester	Course Title
Spring	Business Writing	Fall	Introduction to Linguistics
	Globalization and Japan		Introduction to Environment and Society
	Second Language Acquisition		Introduction to Literature
	Globalization and Cultural Interaction		Introduction to Sustainable Development Goals
	ESL Linguistics		Introduction to Cultural Semiotics
	Model United Nations		Management Basics
	Language and Society		Language Teaching Theories
	Structure and Meaning of Language		Introduction to Tourism Studies
	Reading Japanese Literature		Diversity and Global Perspectives
	Management in English		Multicultural Society and Language
	Tourism in English		Early English Education
	Marketing in English		Issues in Comparative Cultural Analysis
	International Business in English		Interpersonal Communication
	Information Technology in Business in English		Cognitive Linguistics
	Basic Accounting in English		Principles of Conversation and Discourse
	Business Ethics in English		Phonetic Sounds and Pronunciation of English
	Economics in English		Topics in African Societies
English Linguistics A	Issues in Journalism		

*Hours per semester : 45

*Offered courses may change due to the change of the curriculum organization.

Exchange Student Courses (ES courses)

Exchange Student Courses (ES Courses) consists of the following subjects.

- Japanese Conversation Courses

"Conversation" class offers a big chance to improve your Japanese language skills.

Course will be held for level 1 (beginner) to 5 (advanced).

- Japanese Culture Courses

We offer classes that delve into the cultural and social aspects of Japan.



Conversation



Japanese Society & Culture



Japanese Culture BUDO

Housing

All exchange students are required to stay at accommodations that Kindai University arranges.

Before arriving, students must pay full rent for one semester. One semester rent will be 240,000~300,000 yen (Payment method is by credit card only).

Further information will be announced to applicants.



Estimated Living Expenses (per month)

Housing	45,000~50,000 yen (290~320 USD)
Food	30,000~40,000 yen (190~250 USD)
Personal Expenses	30,000~40,000 yen (190~250 USD)
Total	105,000~130,000 yen (670~820 USD)

(USD / JPY = 160)

Language Partner Program (LPP)



Kindai University gives a lot of importance to language learning. Besides the availability of the various language courses in our many faculties, we also have the Language Hub where you can learn a variety of languages.

Language Hub will be running a Language Partner Program (LPP). The purpose of this system is as follows:

- A) To make Japanese friends
- B) To learn and practice Japanese with a native speaker
- C) To teach your native language to a Japanese student

*The duration of the program is until the last day of each semester.

International Exchange Team “Connect”

International Exchange Team “Connect” is a team of students who plan and manage international exchange events with the aim of stimulating exchange between international students and Japanese students at Kindai University.

This team will hold events twice a year (first and second semester), as well as mini events for small groups of students.

Students who want to make friends with Kindai students, we are waiting for your participation.



Kindai Short-Term Japanese Program

Kindai University provides a short term Japanese language/culture program for the students who are currently attending our partner universities.

The program is distinctive in the way that it consists of interaction with Kindai University students and hands-on Japanese traditional culture experiences incl. Budo, the Japanese martial arts.

The Japanese language course is also peculiar in the sense that various levels are available, from elementary level without no learning experience to intermediates.

Program Description

- Japanese Language Course 【34.5 hours (90 min x 23classes)】
- Japanese Culture Experience 【Once a week】
- Interactions with Kindai students

Program Period

Summer Session Early July ~ Mid July (3 weeks)

Winter Session Mid January ~ Early February (3 weeks)

Program Fee (Academic program, accommodation etc.)

250,000 ~ 320,000 yen (1,570~2,000 USD) – per student (USD/JPY = 160)



Please check our website
for more details



Route Map to Kindai University's Main Campus

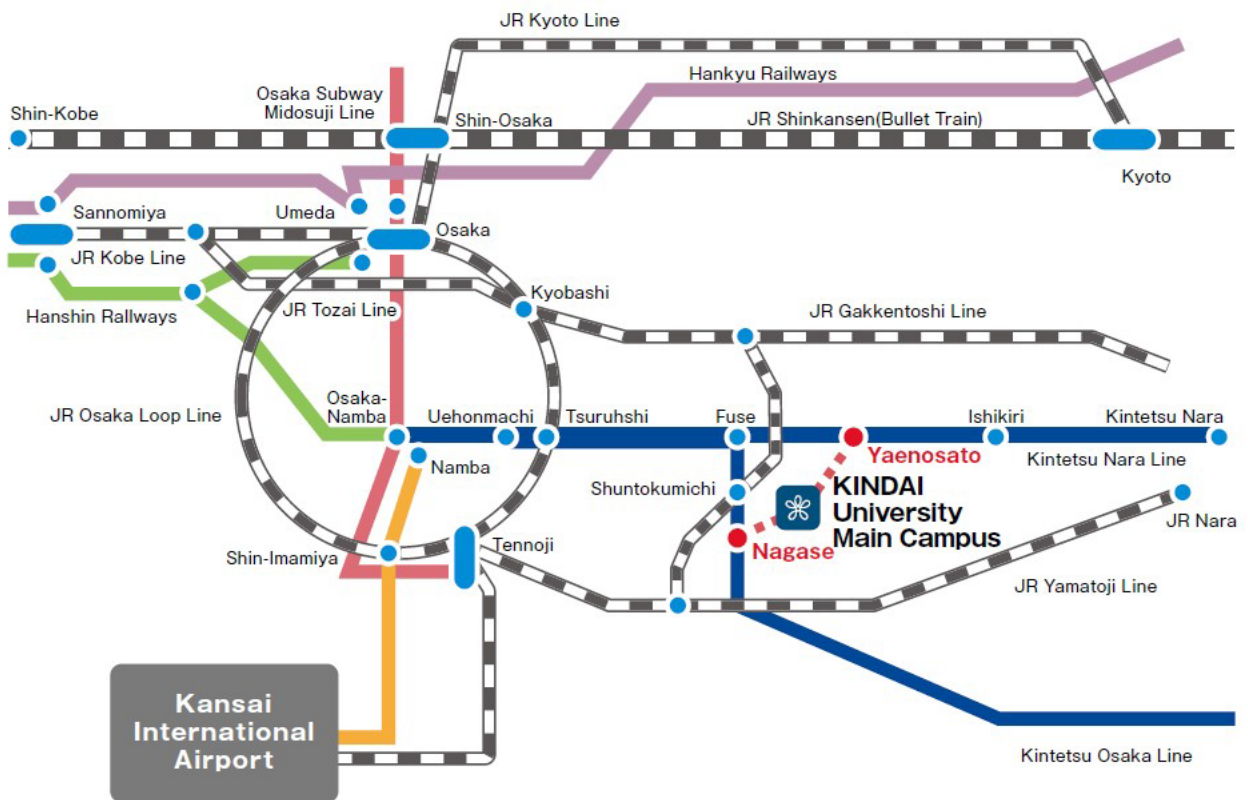

Kindai University Global Education Center

Global Education Center is in charge of all services related to Japanese language education and international exchange.

Please contact us when you have any questions. We always welcome your inquiries.

Address : 3-4-1 Kowakae Higashiosaka Osaka 577-8502 Japan

TEL : +81-6-4307-3081 email : isc@itp.kindai.ac.jp URL : <https://www.kindai.ac.jp>